

# Marin Healthcare District Board Meeting

Marin General Hospital

February 10, 2014



# Agenda

- *Marin County Planning Update*
- *Marin General Site Development*

# *Marin County Planning Update (Kevin Coss)*

# *Marin General Site Development*

# Marin General Site Development Modifications

- Site Design is currently at 95% Design Development
- Marin Design Review Board Site Related Comments
  - Addition of Pedestrian Sidewalk @ Hillside Parking Structure Roadway
  - Revised Two Tier Retaining Wall / Landscape Scheme @ Hillside Parking Structure Roadway
- Hillside Parking Structure Entrance & South Entrance Coordinated For Consistency
- Proposed Signalized Pedestrian Crossing At Main West Wing Entrance (Draft Form)
- Temporary and Future Bus Stops Have Been Adjusted Per County Input

## Marin General Site Development Modifications (Continued)

- Preliminary Pedestrian & Bicycle Circulation Has Been Provided (Draft Form)
- Required Vehicular Parking Counts Have Been Verified For Final Condition and Interim Construction Phases

# Marin General Site Plan

PARKING STRUCTURE

SURFACE PARKING LOT

EXISTING MENTAL HEATH

EXISTING BUS-STOP

PARKING DRIVE ACCESS

EXISTING BUS-STOP

WEST PARKING LOT

EXISTING CENTRAL WING

EXISTING WEST WING

MAIN ENTRY

EXTERIOR GARDEN

PROPOSED SIGNALIZED  
CROSSWALK

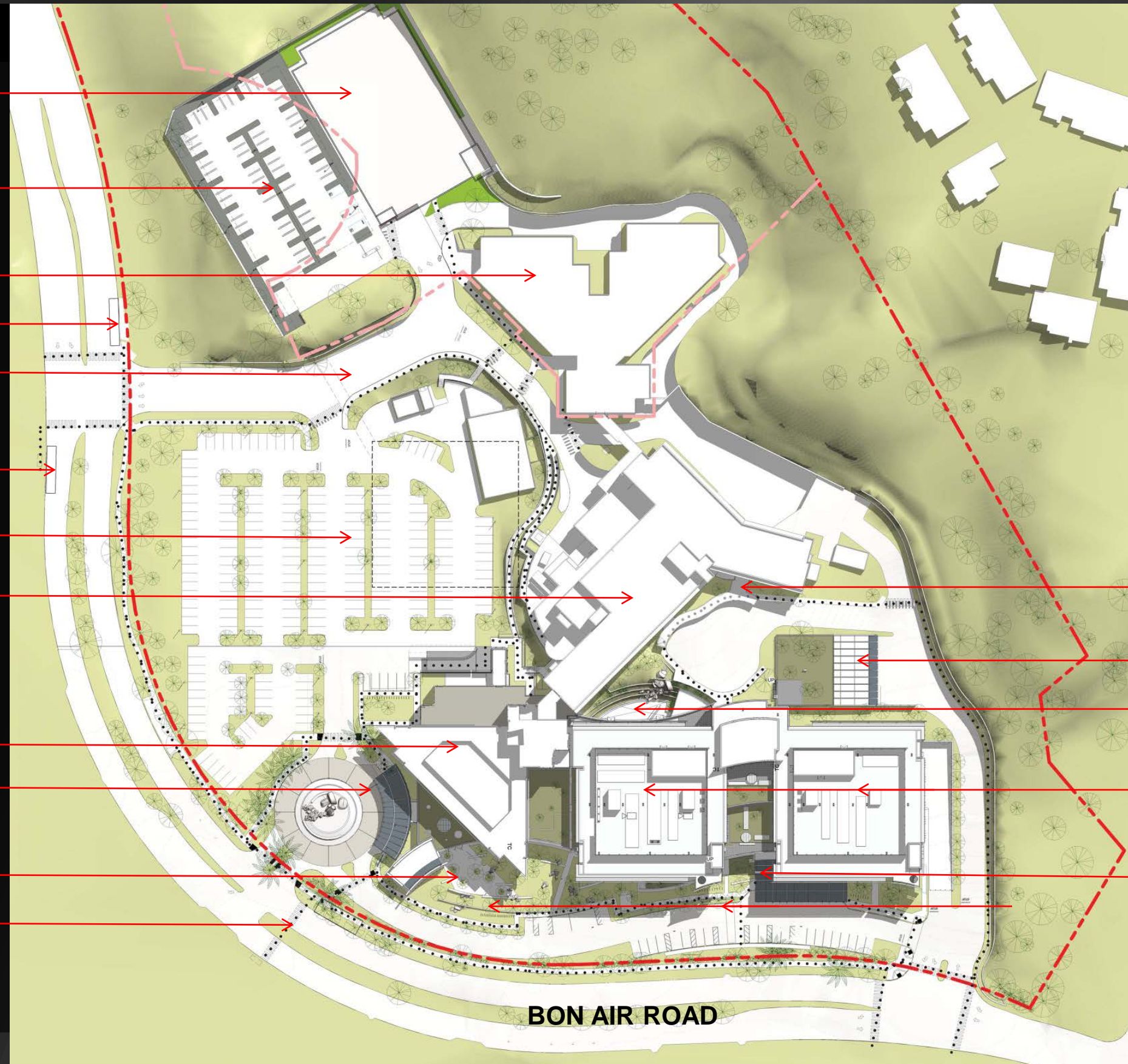

BON AIR ROAD

EXISTING LOBBY ENTRY

PROPOSED LOADING DOCK  
GARDEN

PROPOSED HOSPITAL  
REPLACEMENT BUILDING

EMERGENCY ENTRY

# Marin General Site Plan

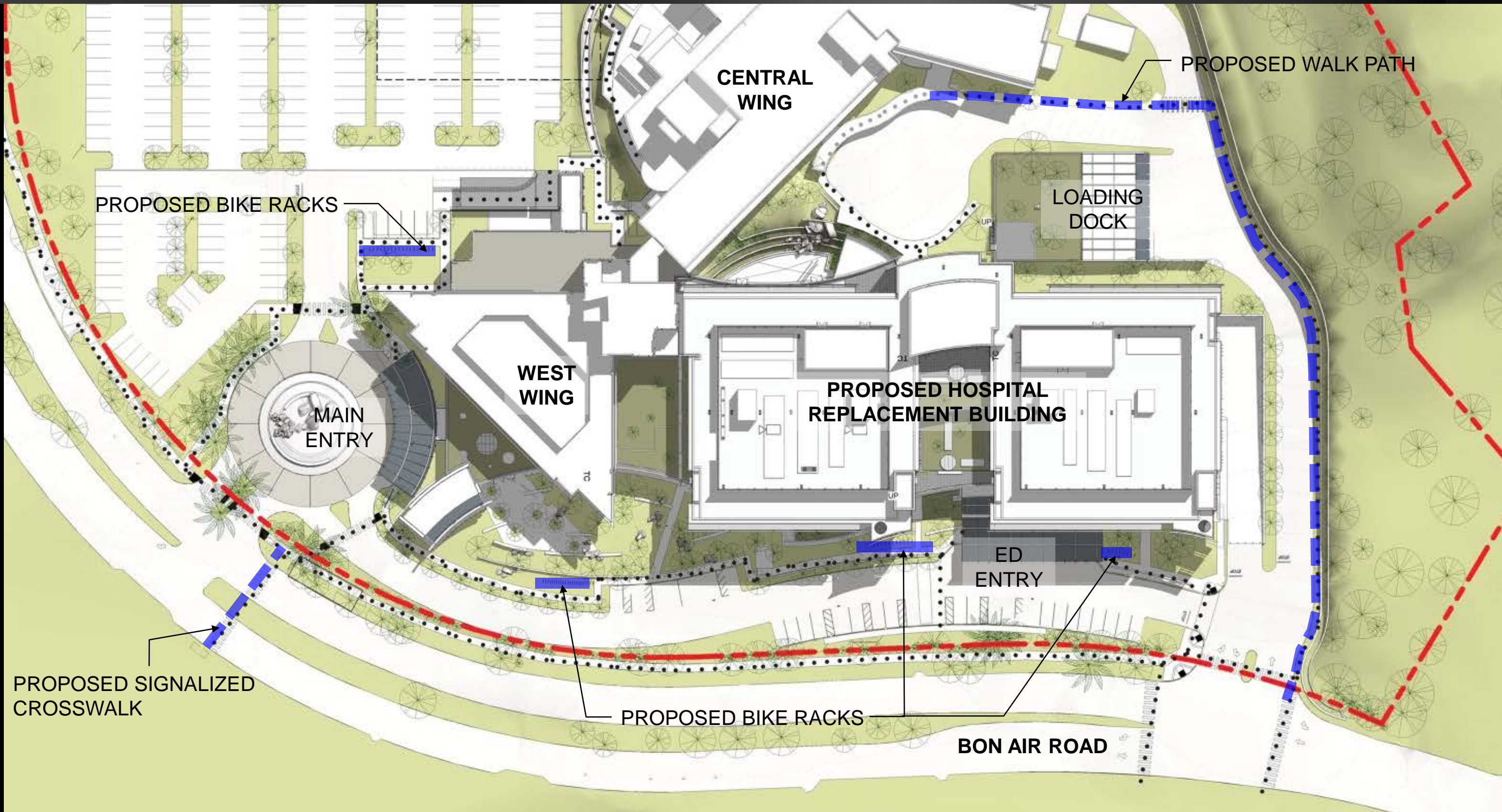



# Marin General Site Plan

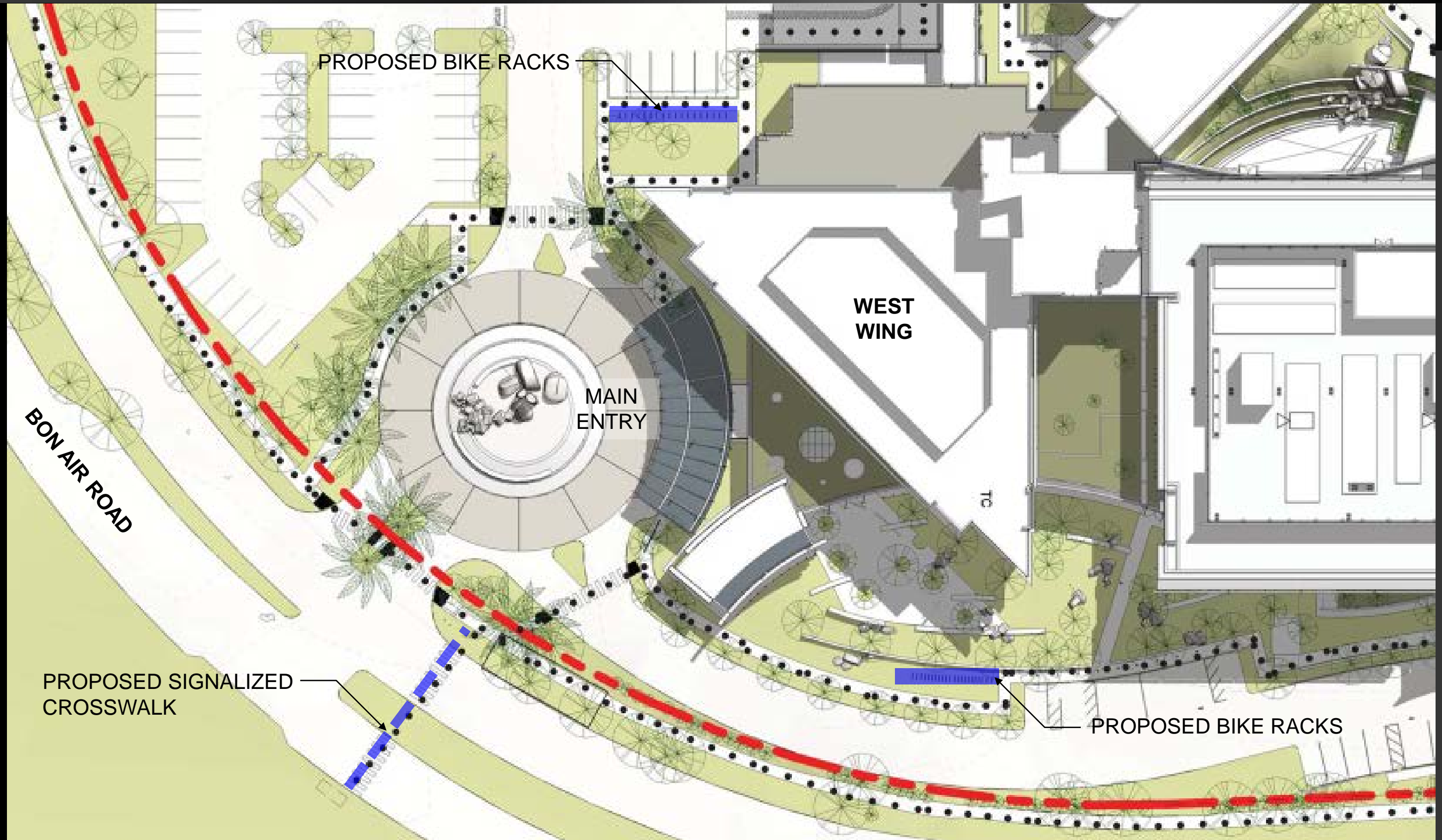

# Marin General Site Plan

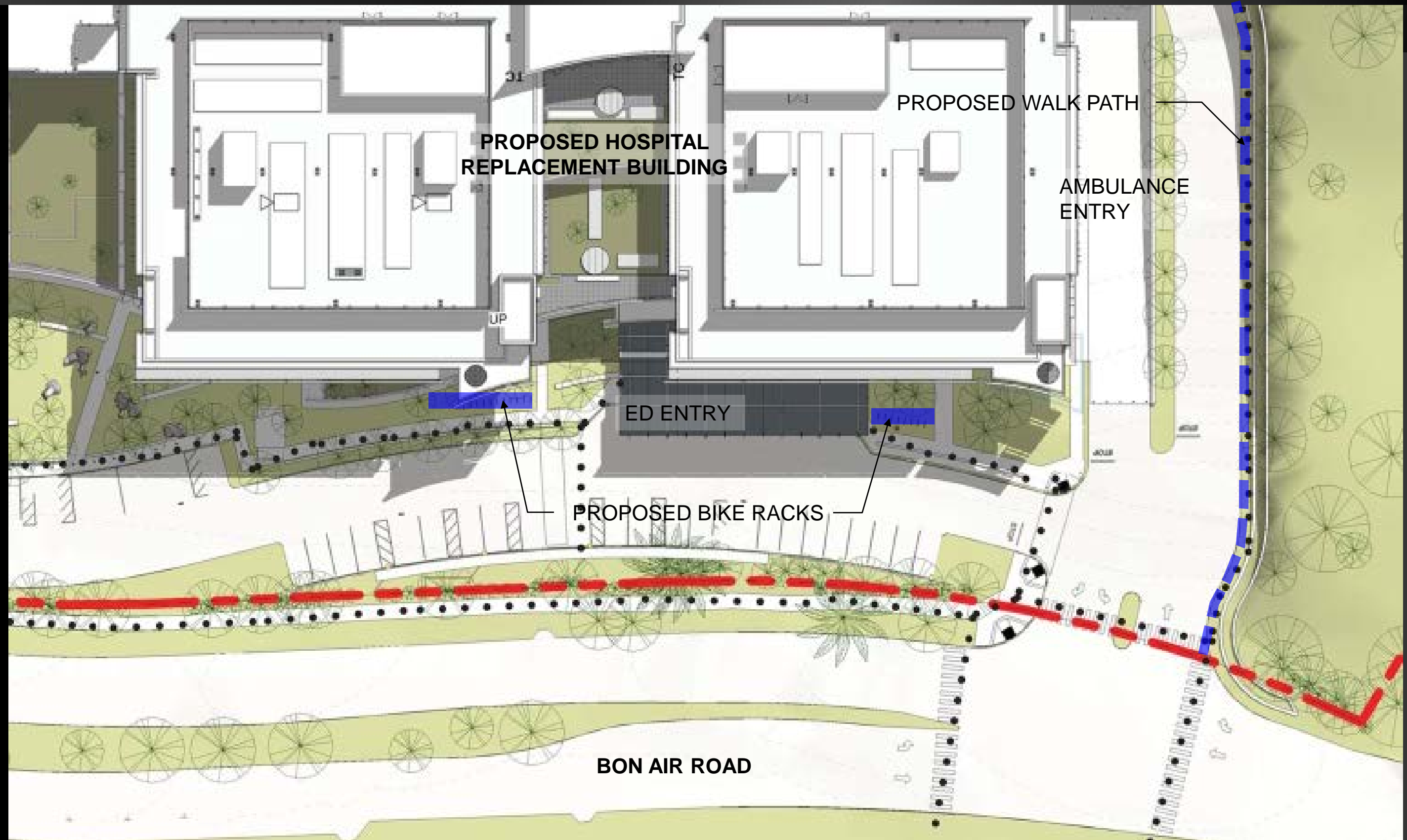

# Marin General Site Plan

